



# ZWPD008008

## 齿轮箱规格 Gearbox specifications

外径	Outer diameter	8mm	轴承	Bearing	烧结轴承	Porous Bearing	滚动轴承	Rolling bearing
材质	Material	塑料 Plastic	轴向窜动	Axial endplay	≤0.3mm		≤0.2mm	
旋转方向	Direction of rotation	cc & ccw	输出轴径向负载	Radial loading on output shaft	≤0.8N		≤5N	
齿轮箱回程差	Gear backlash	≤3°	工作温度	Operating temperature range	-20 ~ +85°C			

## 齿轮级数 Gearbox stages

		1	2	3	4
传动比	Transmission ratio	4 / 5	13 / 19 / 28	47 / 69 / 102 / 152	168 / 249 / 368 / 546 / 809
最大容许扭力 ( gf.cm max )	Max rated torque of gear box	50	100	200	400
瞬间容许力矩 ( gf.cm max )	Instant torque of gear box	200	300	600	900
齿轮箱效率	Gearbox efficiency	85	73	65	58
长度	Length	8.6	11.3	14	16.7

## 推荐产品 | RECOMMENDED PRODUCTS

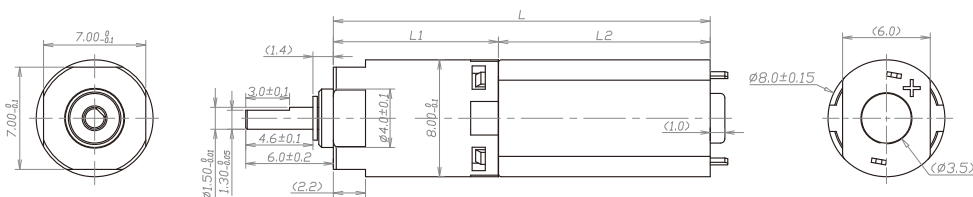

## 马达规格参数 Motor specifications

马达(可选择) Motors(Optional)	直流有刷电机、直流无刷电机、步进电机 DC brush motor, DC brushless motor, Stepper motor	输入速度	Input speed	≤3000rpm
电压(可选择) Voltage(Optional)	3-12V	电流	Current	150MA max

型号 Model	Rated Speed 额定转速	Max Speed 最高转速	Max Rated Torque 额定容许力矩	Max Instant Torque 瞬间容许力矩	Gear Ratio 减速比	Length 减速箱长 L1	Overall Length 总长 L
	rpm	rpm	gf.cm	gf.cm		mm	mm
ZWPD008008-4	2083	8333	50	200	3.6	8.6	23.1
ZWPD008008-5	1406	5625	50	200	5.3		
ZWPD008008-13	579	2315	100	300	13.0	11.3	25.8
ZWPD008008-19	391	1563	100	300	19.2		
ZWPD008008-28	264	1055	100	300	28.4		
ZWPD008008-47	161	643	200	600	46.7	14	28.5
ZWPD008008-69	109	434	200	600	69.1		
ZWPD008008-102	73	293	200	600	102.4		
ZWPD008008-152	49	198	200	600	151.7		
ZWPD008008-168	45	179	400	900	168.0	16.7	31.2
ZWPD008008-249	30	121	400	900	248.8		
ZWPD008008-369	20	81	400	900	368.6		
ZWPD008008-546	14	55	400	900	546.1		
ZWPD008008-809	9	37	400	900	809.1		

注：可根据客户要求定制 Can customize product as requirements